

APPROVED

FOR REFERENCE ONLY

SOCKET SET SCREW, M6x1.0 x 6mm, CUP POINT, ALLOY STEEL

REVISIONS				
ZONE	REV.	DESCRIPTION	DATE	APPROVED
	A	INITIAL RELEASE	5/31/2019	JP

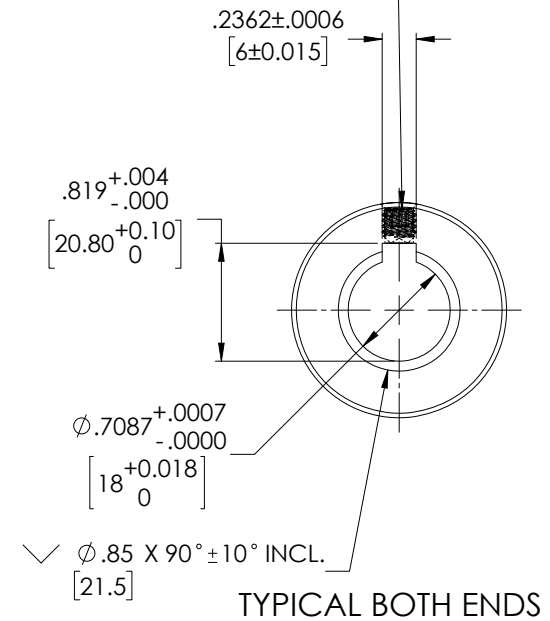
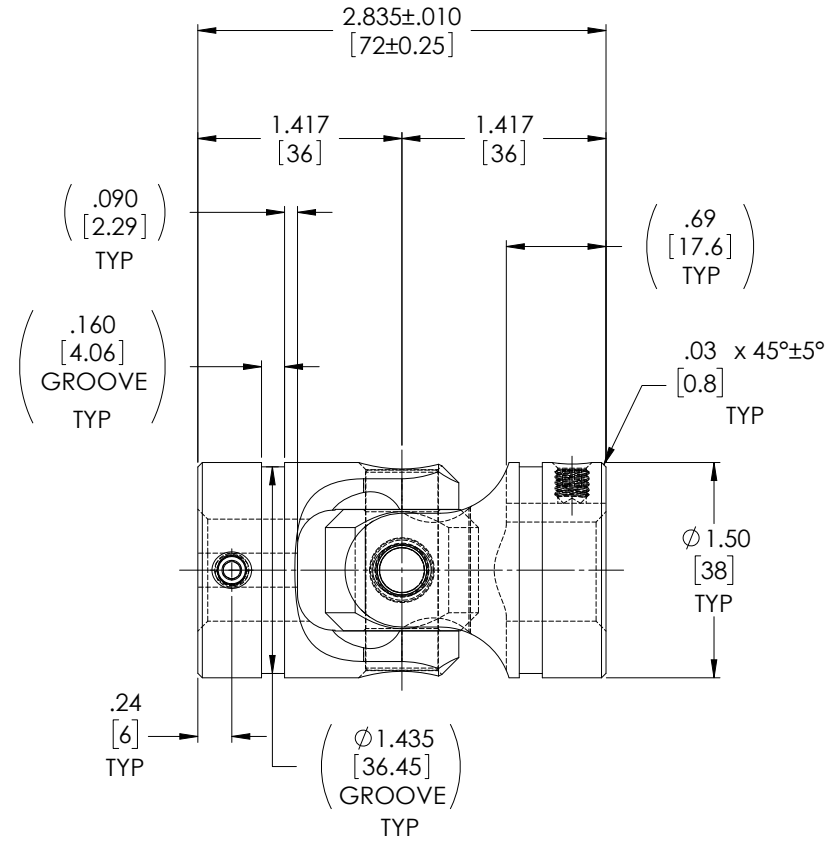
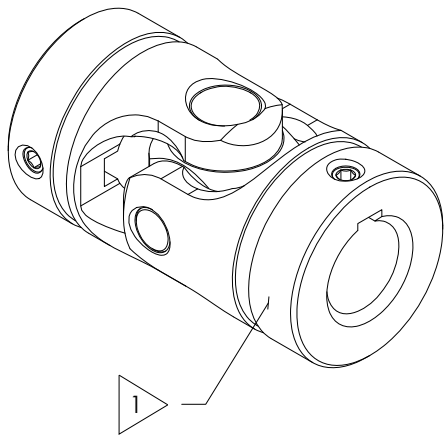

NOTE(s), UNLESS OTHERWISE SPECIFIED.

1 MARK ASSEMBLY w/ "BELDEN" LOGO, PART NUMBER, REVISION LEVEL (IF ANY), DATE OF MANUFACTURE, & BELDEN JOB No.

(2) LUBRICATE U-JOINT w/ LUBRIPLATE # 1200-2, NLGI GRADE 2, AW/EP, LITHIUM GREASE OR EQUIVALENT.

(3) REF., MAXIMUM OPERATING ANGLE: 45°

DO NOT SCALE DRAWING

<small>UNLESS OTHERWISE SPECIFIED CHAMFER ALL HOLES BREAK ALL SHARP CORNERS DE-BURR ALL FEATURES</small>	<small>STANDARD TOLERANCES, UNLESS OTHERWISE SPECIFIED</small> <small>DIMENSIONS ARE IN INCHES [mm]</small> ANGULAR MACHINED: ±1.0° FRACTIONAL: ±.015° TWO PLACE DECIMAL: ±.010° THREE PLACE DECIMAL: ±.005° FOUR PLACE DECIMAL: ±.0005° CONCENTRICITY: .0005" T.I.R.	<small>MATERIAL</small> ALLOY STEEL <small>HEAT TREAT</small> SEE DETAIL DRAWINGS <small>FINISH</small> SEE NOTE(s)	<small>INITIALS</small> JP	<small>DATE</small> 31MAY19	Belden Incorporated www.beldenuniversal.com ASSEMBLY, UNIVERSAL JOINT	
			<small>DRAWN</small> 	<small>CHECKED</small> RNK		<small>DATE</small> 06/24/2019
			<small>ENG APPR.</small> 	<small>MFG APPR.</small> 		<small>DATE</small> 07/22/2019
			<small>QC APPR.</small> 	<small>COMMENTS:</small>		
<small>PROPRIETARY AND CONFIDENTIAL</small> <small>THE INFORMATION CONTAINED IN THIS DRAWING IS THE SOLE PROPERTY OF BELDEN UNIVERSAL. ANY REPRODUCTION IN PART OR AS A WHOLE WITHOUT THE WRITTEN PERMISSION OF BELDEN UNIVERSAL IS PROHIBITED.</small>	<small>ALL HOLES TO BE LOCATED ON CENTERLINE (C) WITHIN .005" T.I.R. INTERPRET GEOMETRIC TOLERANCES I.A.W. ASME Y14.5</small>	<small>SCALE:</small> 3:2	<small>WT (Lbs):</small> 0.955	<small>SHEET 1 OF 2</small>	<small>SIZE</small> DWG. NO. A UJ-HD1500x18K A <small>REV</small>	