

# APPROVED

## FOR REFERENCE ONLY

SOCKET SET SCREW, M6x1.0 x 8mm, CUP POINT, ALLOY STEEL, 2X

REVISIONS				
ZONE	REV.	DESCRIPTION	DATE	APPROVED
	A	INITIAL RELEASE	5/31/2019	JP

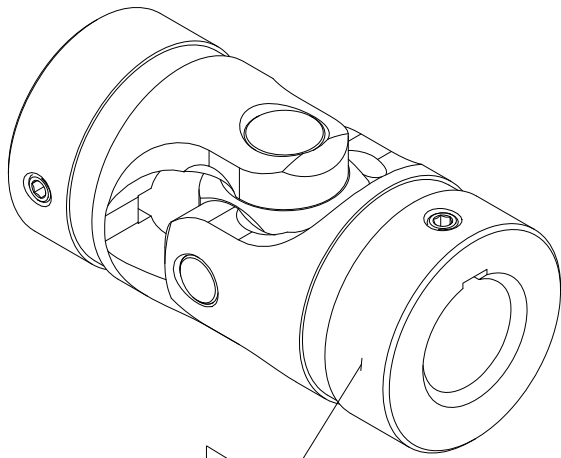

1

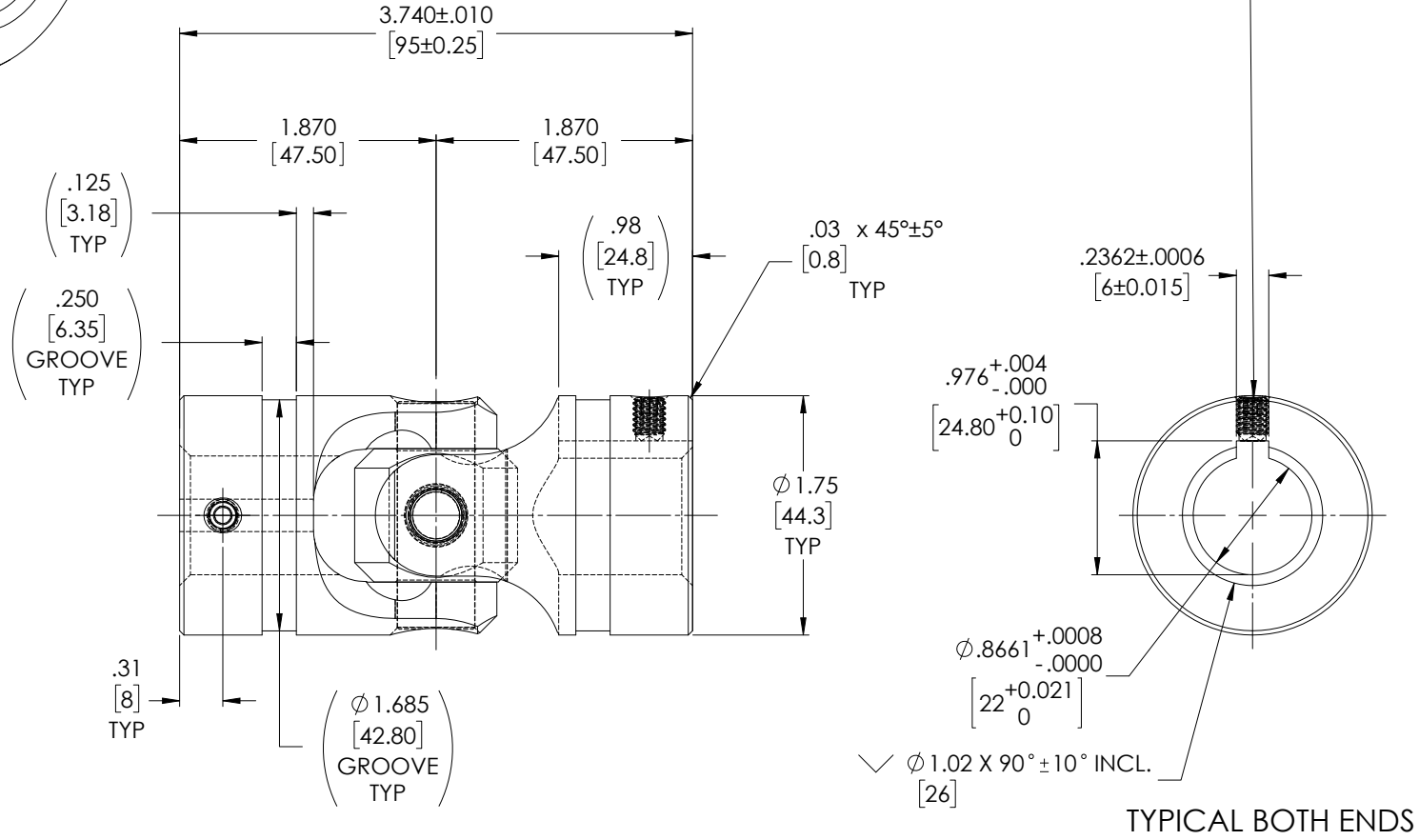

TYPICAL BOTH ENDS

NOTE(s), UNLESS OTHERWISE SPECIFIED.

1 MARK ASSEMBLY w/ "BELDEN" LOGO, PART NUMBER, REVISION LEVEL (IF ANY), DATE OF MANUFACTURE, & BELDEN JOB No.

(2) LUBRICATE U-JOINT w/ LUBRIPLATE # 1200-2, NLGI GRADE 2, AW/EP, LITHIUM GREASE OR EQUIVALENT.

(3) REF., MAXIMUM OPERATING ANGLE:  $45^\circ$

DO NOT SCALE DRAWING

UNLESS OTHERWISE SPECIFIED CHAMFER ALL HOLES BREAK ALL SHARP CORNERS DE-BURR ALL FEATURES TURNED SURFACES: $\sqrt{63}$ FRACTIONAL: $\pm .015$ TWO PLACE DECIMAL: $\pm .010$ THREE PLACE DECIMAL: $\pm .005$ FOUR PLACE DECIMAL: $\pm .0005$ MILLED SURFACES: $\sqrt{125}$ CONCENTRICITY: $\pm .0025$ T.I.R.	STANDARD TOLERANCES, UNLESS OTHERWISE SPECIFIED DIMENSIONS ARE IN INCHES [mm]	MATERIAL ALLOY STEEL	INITIALS DATE	Belden Incorporated <a href="http://www.beldenuniversal.com">www.beldenuniversal.com</a>
	HEAT TREAT SEE DETAIL DRAWINGS	DRAWN JP 31MAY19	CHECKED RNK 06/24/2019	TITLE: ASSEMBLY, UNIVERSAL JOINT
	FINISH NONE	COMMENTS:	SIZE A	DWG. NO. UJ-HD1750x22K
	ALL HOLES TO BE LOCATED ON CENTERLINE (C) WITHIN .005" T.I.R. INTERPRET GEOMETRIC TOLERANCES I.A.W. ASME Y14.5	SCALE: 1.5:1   WT (Lbs): 1.677   SHEET 1 OF 2	REV A	SHEET 1 OF 2